



# GRAND CANYON MODEL RAILROADERS

## MAIN LINE

SEPTEMBER, 2014  
Volume 23      Number 9

### PRESIDENT'S MESSAGE

by John Draftz

September has two special events members need to be aware of.

First, we'll have a GCMR potluck/picnic for members and guests. The goal is to simply meet with each other beyond that of a business meeting. A map is printed elsewhere. The details are:

#### GCMR Potluck/Picnic

**Saturday, September 20th**

**Starts at 6pm**

**Held at George & Dolores Bean's, 14950  
Poinsettia Dr, Surprise**

**Hamburgers, hot dogs, & beverages are  
provided**

**Please bring a salad or dessert**

**RSVP to George (623-975-3823)**

Second, the first annual **Fall Mini-Meet** will be held Saturday, the 27<sup>th</sup>. Sale tables are free and for members only based on a first come first served basis. Supply is limited. Admittance is free. The goals are to give members a chance to sell "stuff" they don't want and to make the public aware of who we are and get them to join us. The format of the mini-meets will be:

#### Fall Mini-Meet

**0080-0830      Sellers set up sale tables.**

**0830-0900      Start regular meeting (secretary  
& treasurer report, monthly raffle ticket sales).**

**0900-1100      Meeting suspended and doors  
open for swap meet. Public becomes our  
invited guests.**

**1100-1130      Meet raffle drawing. Sellers  
pack up sale tables.**

**1130-1200      Regular meeting reconvened (old  
business, new business, monthly raffle**

George Bean (623-975-3823 and [geowbean@verizon.net](mailto:geowbean@verizon.net)) is coordinating sale tables. Contact George to reserve one. Dave Brown (480-650-5336 and [eaglefour@juno.com](mailto:eaglefour@juno.com)) is in charge of operating display layouts at the meet. Contact him if you would like to set up an operating layout.

There will be a meet raffle prize with a must-be-present-to-win drawing at 11am. Tickets will be \$2 each or 3/\$5.

As you can see, our monthly meeting has a split format to accommodate the meet. We'll need help setting up tables and then taking them down. Setting up tables at 7:30am is an option. If there's not a problem with the church, we could possibly set up tables Friday evening. Any thoughts?

October will be the pizza meet with the theme “beverage cars (beer, wine, soda pop, etc)”.

Our next public venue will be Scottsdale’s Railfair on October 11 & 12 where we’ll have both the mobile layout and the modules on display. Jack Eaton (623-249-7297 or [jeaton9@cox.net](mailto:jeaton9@cox.net)) is coordinating the staffing. Please let him know how you can help.

See you September 20<sup>th</sup> at 6pm and September 27<sup>rd</sup> at 8am.

## CALENDAR

*GCMR meets are held at 9:00am in the Parish Hall of Our Saviour's Lutheran Church at 1212 E Glendale Avenue in Phoenix, located on the north side of Glendale, just east of the traffic light at 12th St. It is easily reached off the Glendale Exit of either I-17 or SR 51. Go east from I-17 or west from SR 51 to 12th Street.*

**September 20** - GCMR Potluck/Picnic at George Bean’s home. See the President’s Message for details.

**September 20** - Phoenix Crowne Plaza - Arizona Railroadania Show and Sale 9am - 3pm

**September 27** - GCMR meeting, Our Saviour’s Lutheran Church - Theme: swap meet with the public invited. See the President’s Message for details

**October 11, 12** - Railfair at Scottsdale Railroad Park - GCMR layouts on display

**October 25** - GCMR meeting, Our Saviour’s Lutheran Church - Theme: pizza meet - beverage cars (beer, wine, soda pop, etc) Drag races

**November 14 - 15** TTOM swap meet - Tucson. See flyer this issue.

**November 22** - GCMR meeting. See next month’s newsletter to see if this date will hold.

**November 22, 23** - Cal Stewart meet, Ontario, CA. GCMR trailer at show

**November 29** - Turkey Meat Auction - Shepherd of the Valley Lutheran Church, 15th Ave and Maryland in Phoenix. Catalog \$5 at Desert Division meets or by mail from your Editor

**December 13** - Desert Division Toy Train Show - Glendale

**December 14** - Christmas Party for Desert Division, P&P and GCMR. Mesa. Reservation form in the next issue.

## MEETING NOTES

by Barbara Turner

### Announcements

- Scottsdale’s Railfair will be October 11-12. Both trailers will be there Friday the 10<sup>th</sup>. We may be able to use that time to do minor repairs and adjustments to the trailers/modules. Members who can be there that Friday afternoon are encouraged to attend.

- There will be a members & guests potluck September 20<sup>th</sup> at the Bean’s at 6pm. Those who are planning to attend should contact George to let him know how many will attend.

- The September meeting theme is the fall Mini-Meet from 9 to 11am. Tables are free to members and admission is free. Members wanting a table should contact George Bean.

## Board of Directors

President: JOHN DRAFTZ 602-942-3457  
Vice Pres: JACK EATON 623-249-7297  
Secretary: BARBARA TURNER 602-430-6306

Treasurer: GLENN SABER 602-956-6696  
Board Member: DAVE BROWN 480-650-5336  
GEORGE BEAN 623-975-3823  
BILL RICHARDSON 623-582-5672

Editor: Peter Atonna 928-636-4228 [mjatonna@gmail.com](mailto:mjatonna@gmail.com) - Website: [www.gcmrr.org](http://www.gcmrr.org)

## Show and Tell

- Jack Eaton brought an O-gauge RMT Budd car that he also used as his temperature entry.

- Dallas Dixon brought an O-gauge Santa Fe passenger train.

- Bill Richardson brought an HO diesel powered freight train.

- Dave Brown held an LED wiring clinic.

-Guess the Heat entries included:

85	Bill Richardson - locomotive
90	Glenn Saber - passenger car
93	Jack Eaton - Budd car
100	John Draftz - boxcar

The time at 11am was 88 thus Glenn was closest and won six monthly raffle tickets

## Old Business

- Beat the Heat: Dave gave a bus trip and layout tour report. John will send a snail mail thank you to the four hosts on behalf of the GCMR. The bus cost more than previous years and the number of riders was less than the break even number. Dave will contact the bus companies to see what options there are for less expensive buses for next year. An increase in the per person cost may be needed.

- Swap Meet: John indicated the pre-meet activities will begin in about a month. We'll need to wait 'til October 1<sup>st</sup> to verify the date of the meet after which advertising can begin.

- Permanent Location: John reported that there is little new information on a permanent location. At Adobe Mountain, the fire hydrant issue is still unresolved along with what buildings fall under the restrictions, e.g., would a mobile home be considered a permanent structure. Barbara is still looking into the possibility of something being available in Mesa, possibly in Pioneer Park,

since many of our public venues are now on the east side.

- Service Work: George serviced the O gauge engines and noted the cheaper one was not repairable. Bill Richardson will service the S gauge engines. John will try to service the HO engines. Bob Dennison provided some needed couplers for the pre-war freight cars.

- Mini-Meet: The fall mini swap meet will be September 27<sup>th</sup>. Flyers have been distributed. PSAs and other media contacts will go out after Labor Day. A raffle prize needs to be identified. Tables are for members. If there are still tables available after a member gets one, a second table can then be obtained by a member. Members were encouraged to bring those trains and other items that they may not want but that the public might, e.g., HO & N gauge.

## New Business

- Other Venues: Members were asked to think about what other venues the club might become involved with. John noted that Dave, Glenn and he are, at present, the only sources for towing the trailers thus other venues would involve their availability. Art Triant suggested the possibility of a Christmas themed layout that could be displayed. Such layouts would need to be designed and constructed so as to be transported in member vehicles.

- Non-meeting Activities: Members were asked to think about what other non-meeting activities they might want to have.

## **BEAT THE HEAT**

This year's annual bus trip to Prescott for the Beat the Heat swap meet is now history for one more year. Dave Brown, in his



traditional role, organized the trip and was responsible for over 30 folks having a great day while leaving the “driving to us”. With this year’s summer rains, the North Country was lush green and the temperatures warm and sunny. Crowds at the meet were very good and hopefully bus riders found a few goodies to bring back to the Valley. (As you know, your Editor is breaking down his layout and had stacks of items not to be used on his revised, new layout. And several GCMR members did come home with my goodies)

Following are some photos from the trip:



**People enjoy the vast assortment of train related items as well as the Christmas theme pare of Marlin Benson’s layout.**



**The GCMR folks were among the last to see the Atonna layout as demolition began a week later in preparation for a new layout with a different theme**







Donn Pease continues progress on his HO gauge layout depicting the SP in Southern Arizona



Mark Ziven was a new stop on the tour and in fact the bus group were the only ones to see his layout complete with rural and very urban scenes



Warren Webster has an outdoor G scale layout in a beautiful setting around his house

## **WINNERS!**

### **Monthly raffle**

- George Bean – Lionel bunk car
- Jack Eaton – Lionel boxcar
- Bill Richardson – Lionel flat car
- Glenn Saber – two CTT magazines
- Art Triant – Lionel boxcar

### **Mystery box**

- Jack Eaton – K-line Coke handcar & trailer

### **Annual raffle**

- Bill East - 3 raffle tickets.





**To George Bean's Home  
14950 Pointsettia Dr.  
Surprise**

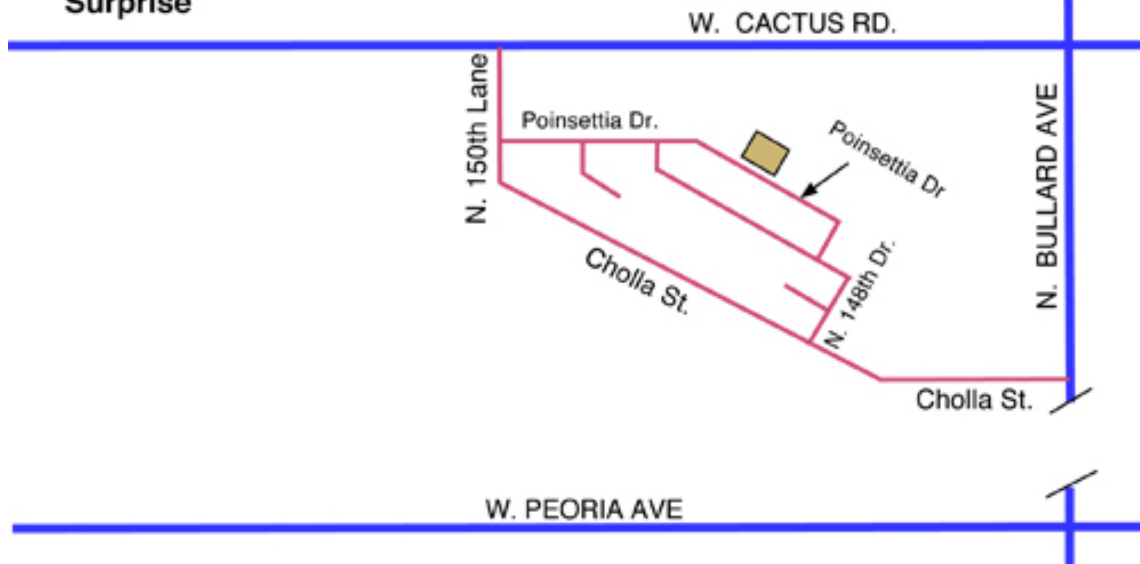



## TUCSON ARIZONA TOY TRAIN SHOW

Gadsden-Pacific Fall Meet **NOV. 14-15 2014**

**PRE-REGISTRATION TABLES: \$35.00 EACH. IF PAYMENT RECEIVED TEN BUSINESS DAYS PRIOR TO EVENT. LAST MINUTE REGISTRATION \$40.00 PER TABLE.**

**LIMITED HELPER PASSES WILL BE INCLUDED IN THE TABLE PRICE**

**When filling out Event Table Registration Form use the name you like to be called and fill in your helper pass name if needed on special instructions line.**

**TABLES are LIMITED**

**Buy three tables get fourth table free!**

**LOCATION: TUCSON AZ. - TUCSON EXPO CENTER SOUTH HALL, 3750 E. IRVINGTON ROAD JUST OFF I-10 exit 264 (IRVINGTON & PALO VERDE)**

**SET UP TIME: SET UP FRIDAY FROM 11:00 AM UNTIL 2:00 PM. OR SATURDAY FROM 7:00 AM UNTIL 9:00 AM. OVERNIGHT SECURITY FOR VENDORS**

**TWO DAY SHOW: UP TO TEN HOURS OF SALES OVER TWO DAYS:  
FRIDAY FROM 2:00 PM UNTIL 7:00 PM & SATURDAY FROM 9:00 AM UNTIL 2:00 PM**

**EIGHT FOOT TABLES: YES, WE WILL HAVE EIGHT FOOT TABLES!  
ELECTRIC - OUTLET AVAILABLE ON PRE-REQUEST.**

**CLEAN FACILITIES, GOOD LIGHTING & REASONABLY PRICED SNACK BAR, NEARBY RESTAURANTS AND MOTELS.**

**Make Checks Payable to: GPD TTOM**

**Mail to: Dave Hoverstock, Meet Chairman (520) 909-0722 or (520) 298-5442  
PO Box 17746  
Tucson, AZ 85731**

**E-mail: [TrainShow@gpdToyTrainMuseum.com](mailto:TrainShow@gpdToyTrainMuseum.com)**

**FUTURE SHOWS: JANUARY 9-10, 2015 MAY 29-30, 2015**

- - - - - Cut Registration Form Here - - - - -

<b>TUCSON ARIZONA - TOY TRAIN SHOW</b>			
<b>Gadsden-Pacific Fall Meet <b>NOV. 14-15 2014</b></b>			
<b>EVENT TABLE REGISTRATION FORM</b>			
Name	Mailing Address		
Email Address	City	State	Zip
Phone	Check Number	Enclosed \$	# Tables Ordered
Special Instructions:		Helper Name:	

## **THE MAIN LINE**

**Peter Atonna, Editor**

**252375 N. Feather Mountain Rd.**

**Paulden, AZ 86334**



**Dave Brown has become the Impresario of the Beat the Heat Bus Tour Trip. He can now relax as it is under way and there are a couple of hours to get from the valley to pine country and toy trains.**